

FILE NAME AND PATH: C:\Users\Stephanie.B.A. Inc\Desktop\BLA Inc Dropbox\BLA Inc Team Folder\RCP\Reg-190201 DISD STAG Pleasant Grove\04-CD DD\Sheet Files\CD\Reg-190201 DISD STAG Pleasant Grove Landscape.dwg
 PLOT DATE AND TIME: 12/7/2022 7:16 AM

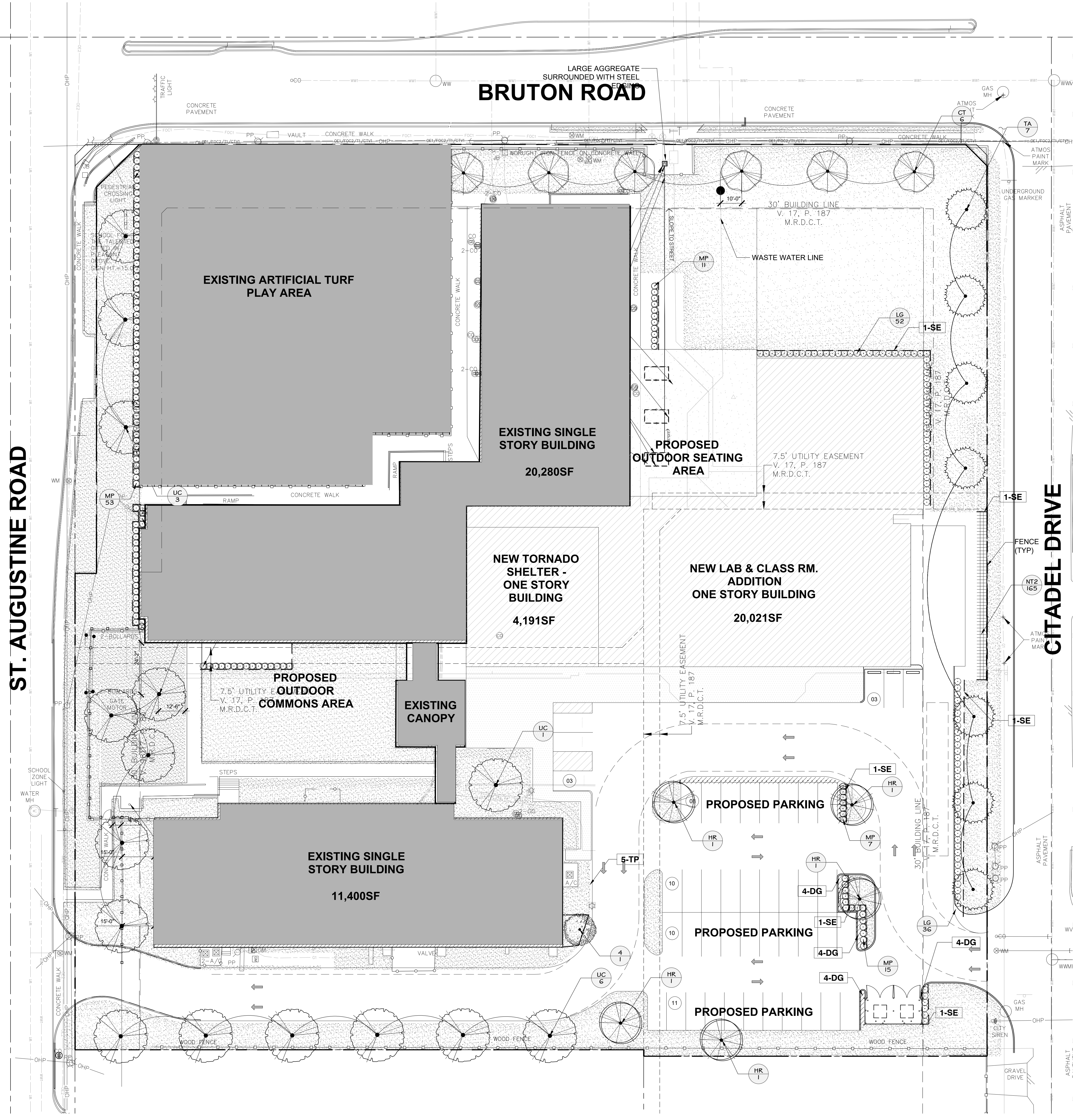

1 LANDSCAPE PLAN
 1"=20'-0"

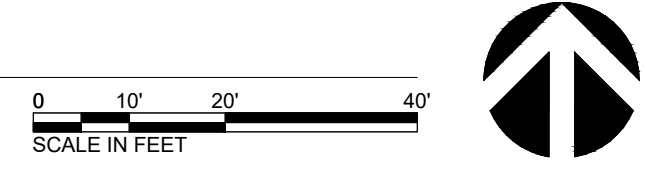

GENERAL PLANTING NOTES

- CONTRACTOR SHALL ADHERE TO CITY CONSTRUCTION REQUIREMENTS INCLUDING BUT NOT LIMITED TO ANY PERMITS, INSPECTIONS, AND METHODS OF MATERIAL INSTALLATION.
- CONTRACTOR SHALL ADHERE TO ALL AGENCY REQUIREMENTS MEANS AND METHODS OF CONSTRUCTION.
- CONTRACTOR SHALL VERIFY THE LOCATION OF ALL UTILITIES ABOVE AND BELOW GRADE, AS WELL AS FINDING OUT EACH COMPANY'S RESTRICTIONS ON WORKING WITHIN THEIR EASEMENTS AND UTILITY LINES PRIOR TO COMMENCING CONSTRUCTION.
- CONTRACTOR SHALL VERIFY LOCATION OF ALL EXISTING IMPROVEMENTS AND TO NOT DISTURB THOSE THAT ARE OUTSIDE OF THE SCOPE OF WORK. ANY STRUCTURES THAT ARE TO REMAIN WITHIN THE SCOPE OF WORK AREA SHALL NOT BE DAMAGED. PHOTOGRAPHS AND NOTES SHOULD BE MADE FOR ANY EXISTING DAMAGED CONDITIONS PRIOR TO COMMENCING CONSTRUCTION AND DISTRIBUTED TO OWNERS REPRESENTATIVE.
- A LANDSCAPE IRRIGATION PLAN SHALL BE PREPARED PRIOR TO LANDSCAPE CONSTRUCTION AND WILL BE DESIGNED BY A TEXAS LICENSED IRRIGATION DESIGNER. ALL PLANTING AREAS SHALL BE IRRIGATED WITH AN AUTOMATIC IRRIGATION SYSTEM WITH A FREEZE AND RAIN SENSOR. THE SYSTEM SHALL BE DESIGNED TO MEET THE CITY AND STATE IRRIGATION REQUIREMENTS. THE IRRIGATION INSTALLER SHALL BE A STATE OF TEXAS LICENSED IRRIGATION DESIGNER.
- CONTRACTOR SHALL NOTIFY OWNERS REPRESENTATIVE IF THERE ARE ANY WATER RESTRICTIONS AND WHAT IF ANY IMPACT THIS MAY HAVE ON THE INSTALLATION OF PLANT MATERIAL.
- QUANTITIES SHOWN IN PLANT LIST FOR PLANT MATERIAL AREA PROVIDED AS A COURTESY FOR THE CONTRACTOR. CONTRACTOR SHALL VERIFY PRIOR TO BIDDING THAT THE QUANTITY WILL COVER THE SPECIFIED AREA AT THE SPACING STATED IN THE PLANT LIST UNDER THE REMARKS COLUMN. IF THERE IS A DIFFERENCE, THE CONTRACTOR SHALL MAKE NOTE ON THEIR BID AND SHOW THE ADDED OR REDUCED COST.
- CONTRACTOR SHALL ESTABLISH SOURCES FOR ALL PLANT MATERIAL ON PLANT LIST WHEN BIDDING PROJECT. NO PLANTS SUBSTITUTIONS.
- CONTRACTOR SHALL BECOME FAMILIAR WITH THE DRAWINGS FOR THIS PROJECT PRIOR TO INSTALLATION.
- IT IS THE RESPONSIBILITY OF THE CONTRACTOR TO ADVISE THE OWNERS REPRESENTATIVE OF ANY CONDITION FOUND ON-SITE WHICH PROHIBITS INSTALLATION AS SHOWN ON THESE PLANS.
- ALL NEW PLANTING BEDS SHALL HAVE A MINIMUM SIX (6") INCHES OF BED PREPARATION.
- LAWN AREA SHALL HAVE FERTILE AND CLEAR TOP SOIL TILLED 4" DEEP.
- GRADING IN PLANTING BEDS SHALL BE SMOOTH AND PROVIDE POSITIVE DRAINAGE.
- CONTRACTOR SHALL STAKE OUT LOCATION OF ALL TREES, AND SHRUBS FOR APPROVAL BY OWNERS REPRESENTATIVE PRIOR TO PLANTING.
- MULCHING OF SHRUB AND ANY GROUND COVER AREAS SHALL HAVE 3 INCHES OF SHREDDED HARDWOOD MULCH.
- LANDSCAPED AREAS SHALL BE KEPT FREE OF TRASH, LITTER, WEEDS, AND OTHER SUCH MATERIAL OR PLANTS NOT A PART OF THE LANDSCAPING.
- THE PROPERTY OWNER, TENANT AND ANY AGENT THEREOF SHALL BE JOINTLY AND SEVERALLY RESPONSIBLE FOR THE MAINTENANCE OF ALL LANDSCAPING MATERIALS IN GOOD CONDITION AT ALL TIMES SO AS TO PRESENT A HEALTHY, NEAT AND ORDERLY APPEARANCE. ANY LANDSCAPING MATERIAL THAT DIES SHALL BE REPLACED WITH HEALTHY MATERIAL WITHIN A REASONABLE TIME. ALL LANDSCAPED AREAS SHALL BE CONTINUOUSLY MAINTAINED FREE OF WEEDS, DEBRIS AND LITTER. WEEDS AND NATURAL UNCULTIVATED GRASS SHALL NOT BE CONSIDERED LANDSCAPING.

REFERENCE NOTES SCHEDULE

SYMBOL	DESCRIPTION
1-SE	STEEL EDGING: 3/16" THICK X 4" WIDE ONLY 1/2" EXPOSED ABOVE SOIL LINE OF SOD
4-DG	DECOMPOSED GRANITE 3" PLACED OVER FILTER FABRIC
5-TP	TREE PRESERVATION FENCE

LANDSCAPE LEGEND

EXISTING TREES	CODE	COMMON NAME
	4	CEDAR ELM 10"
LARGE TREES	CODE	COMMON NAME
	HR	HIGH RISE LIVE OAK
	TA	POND CYPRESS
	UC	CEDAR ELM
MEDIUM TREES	CODE	COMMON NAME
	CT	TEXAS REDBUD
SHRUBS	CODE	COMMON NAME
	LG	GREEN CLOUD TEXAS RANGER
	MP	DWARF SOUTHERN WAX MYRTLE
GROUND COVERS	CODE	COMMON NAME
	NT2	MEXICAN FEATHERGRASS
SOLID SOD	CODE	COMMON NAME
	CH	BERMUDA GRASS

PLANT SCHEDULE

EXISTING TREES	QTY	COMMON / BOTANICAL NAME	SIZE	CONTAINER	HEIGHT	SPREAD
4	1	CEADAR ELM 10"	10"			
		ULMUS CRASSIFOLIA				
LARGE TREES	QTY	COMMON / BOTANICAL NAME	SIZE	CONTAINER	HEIGHT	SPREAD
5	5	HIGH RISE LIVE OAK	3" CAL.	POT	10'-12'	3'-4'
		QUERCUS VIRGINIANA 'HIGH RISE'				
7	7	POND CYPRESS	3" CAL.	POT	8'-10'	3'-4'
		TAXODIUM ASCENDENS				
15	15	CEDAR ELM	3" CAL.	POT	10'-12'	8'-10'
		ULMUS CRASSIFOLIA				
MEDIUM TREES	QTY	COMMON / BOTANICAL NAME	SIZE	CONTAINER	HEIGHT	SPREAD
6	6	TEXAS REDBUD	3" CAL.	POT	8'-10'	8'-10'
		CERCIS CANADENSIS TEXENSIS				
SHRUBS	QTY	COMMON / BOTANICAL NAME	SIZE	CONTAINER	HEIGHT	SPREAD
94	94	GREEN CLOUD TEXAS RANGER	3 GAL.	POT	20'-22"	24"
		LEUCOPHYLLUM FRUTESCENS 'GREEN CLOUD' TM				
125	125	DWARF SOUTHERN WAX MYRTLE	3 GAL.	POT	16'-18"	12'-16"
		MYRTICA PUSILLA				
GROUND COVERS	QTY	COMMON / BOTANICAL NAME	SIZE	CONTAINER		SPACING
165	165	MEXICAN FEATHERGRASS	1 GAL.	POT		18" o.c.
		NASSELLA TENUISSIMA 'PONY TAILS'				
SOLID SOD	QTY	COMMON / BOTANICAL NAME	SIZE	CONTAINER		SPACING
50,825 SF	50,825 SF	BERMUDA GRASS				
		CYNODON DACTYLON '419 HYBRID'				

DRAWN BY: SCB
 CHECKED BY: DLB
 DATE: 12-05-2022
 ISSUED FOR PERMIT:
 ISSUED FOR PRICING:
 REVISIONS:

No.	Description	Date

© 2009 by RPGA Design Group, Inc.
 All Rights Reserved.
 This representation is based on information furnished by the client and is not a warranty, contract, offer or estimate.
 It may not be reproduced in any form without the written permission.

JAL Architect Group, Inc.
 2695 Villa Creek Drive, Suite 206
 Dallas, Texas 75234
 972.620.7377

RPGA DESIGN GROUP, INC.
 ARCHITECTURE
 SPACE PLANNING
 INTERIORS
 101 S. BURNHAMME AVE., SUITE 400 FORT WORTH, TEXAS 76104 817.333.9477 FAX: 817.333.9697
 WWW.RPGAARCHITECTS.COM

VICTORY PARK STUDIOS, LLC
 LANDSCAPE ARCHITECTURE, ENGINEERING AND PLANNING
 10100 W. HIRSHMAN AVE., SUITE 100 FORT WORTH, TEXAS 76154 817.333.9477 FAX: 817.333.9697
 WWW.VICTORYPARKSTUDIOS.COM

E363. NO. P0027-3
SCHOOL FOR THE TALENTED AND GIFTED
IN PLEASANT GROVE
 9610 BRUTON ROAD DALLAS, TEXAS 75217

2015 DALLAS ISD BOND PROGRAM

RESERVED LANDSCAPE ARCHITECT
 STATE OF TEXAS
 1763
 William C. Carter, Jr.

SHEET DESCRIPTION:
 SHEET NO.